

## RDC 160 Hot Water Storage Tank

	<b>Main features</b>	
	Application	Hot water tank intended for DHW heating, with integrated enamelled heat exchanger. It comes fitted with insulation and a magnesium anode rod that protects its inner surface from corrosion. As an option, an electronic anode rod can be installed instead of the magnesium one, for the codes see the Accessories table. If desired, an electric heating element can be installed into the hot water tank.
	Working fluid	water (tank), water, water/glycol mixture (max. 1:1) or water/glycerine mixture (max. 2:1) (heat exchangers)
	Code	<b>12772</b>
<b>Energy Efficiency Data (as per EC Regulation No. 812/2013)</b>		
Energy efficiency class	C	
Standing loss	75 W	
Storage volume	152 l	

<b>Technical data</b>	
Total tank volume	157 l
Fluid volume in tank	152 l
Heat exchanger (HE) volume	5 l
Heat exchanger surface area	0,8 m <sup>2</sup>
Max. working temperature in tank	95 °C
Max. working temperature in HE	110 °C
Max. working pressure in tank	10 bar
Max. working pressure in HE	10 bar
Tank diameter	500 mm
Tank diameter with insulation	584 mm
Tank overall height	1074 mm
Tipping height	1230 mm
Empty weight	70 kg

<b>Hot water heating from 10 °C to 45 °C at heating water inlet temp. 60°C</b>	
Heat exchanger	320 l/h (13 kW)

<b>Materials</b>	
Tank material	S235JR, inner surface enamelled (DIN 4756)
Heat exchanger material	S235JR+N, outer surface enamelled (DIN 4756)
Tank perimeter insulation	PUR foam (hard)
Insulation's outer surface	plastic

<b>Accessories</b>	
El. heating element	models ETT-A, D, F, G, M
Heating elem. max. length / output	495 mm / 6,0 kW
Electronic anode rod	code 9173

<b>Spare parts (magnesium anode rods)</b>	
Mg anode rod A1 (G 5/4")	code 4025
Mg anode rod (G 5/4") with flange and gasket	code 15846

## RDC 160 Hot Water Storage Tank

### Heat exchanger pressure drop

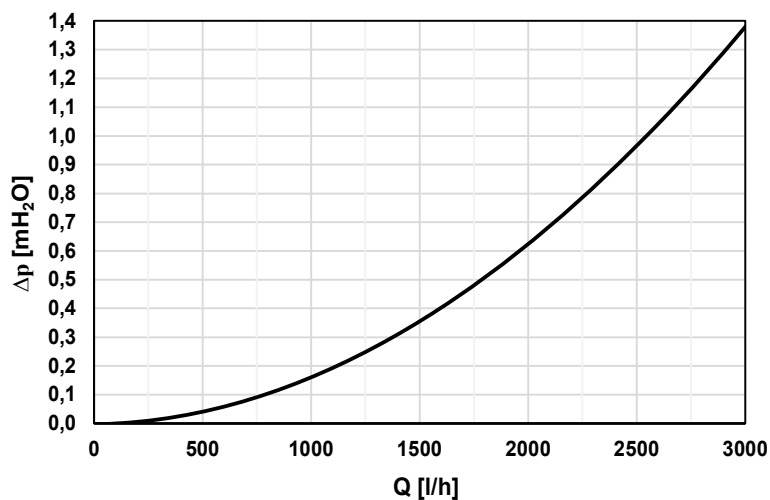

### Dimensions

pos.	description	connection	height [mm]
<b>DHW heating</b>			
W1	cold water	G 3/4" M	73
W2	hot water	G 3/4" M	964
W3	recirculation	G 3/4" F	647
<b>Auxiliary heat source</b>			
E1	electric heating element	G 6/4" F	547
<b>Control and safety</b>			
C2	temperature sensor-lower	G 1/2" F	411
<b>Heat sources</b>			
X1	supply from solar thermal collectors	G 3/4" M	512
X2	return to solar thermal collectors	G 3/4" M	204
<b>Others</b>			
A1	magnesium anode rod	G 5/4" F	1010

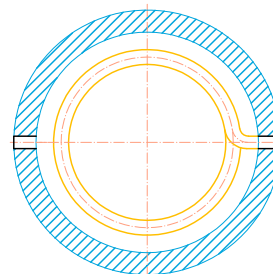
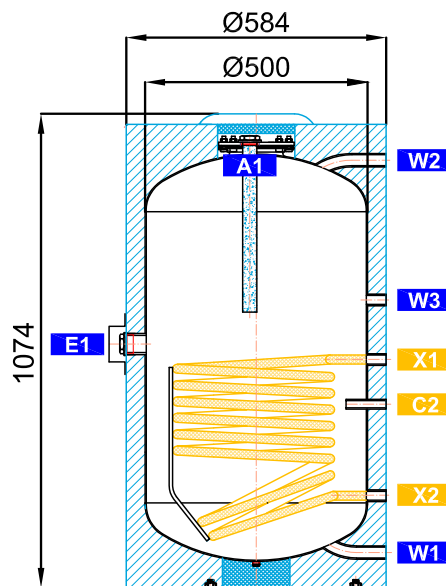

#### NOTE:

- 1) C1 and C2 tappings are supplied incl. adapter G 1/2" M - M12x1.5 and cable gland
- 2) earthing metal strip is run through the insulation next to the upper flange